



**COTSWOLD
DISTRICT COUNCIL**

Dated 16th February 2017

**COTSWOLD DISTRICT COUNCIL
TREE PRESERVATION ORDER NO 17/0001**

Buckle Mill, Honeybourne Road, Weston Subedge

Town and Country Planning Act 1990

**The Town and Country Planning (Tree Preservation)(England)
Regulations 2012**

TREE PRESERVATION ORDER

relating to

Buckle Mill, Honeybourne Road, Weston Subedge

**TOWN AND COUNTRY PLANNING ACT 1990
THE TOWN AND COUNTRY PLANNING (TREE
PRESERVATION)(ENGLAND) REGULATIONS 2012**

**COTSWOLD DISTRICT COUNCIL TREE PRESERVATION ORDER
NO 17/00001**

Buckle Mill, Honeybourne Road, Weston Subedge 2017

The Cotswold District Council, in exercise of the powers conferred on them by section 198 of the Town and Country Planning Act 1990 make the following Order-

Citation

1. This Order may be cited as TPO Number 17/00001 Buckle Mill, Honeybourne Road, Weston Subedge

Interpretation

2. (1) In this Order "the authority" means the Cotswold District Council.
(2) In this Order any reference to a numbered section is a reference to the section so numbered in the Town and Country Planning Act 1990 and any reference to a numbered regulation is a reference to the regulation so numbered in the Town and Country Planning (Tree Preservation)(England) Regulations 2012.

Effect

3. (1) Subject to article 4, this Order takes effect provisionally on the date on which it is made.
(2) Without prejudice to subsection (7) of section 198 (power to make tree preservation orders) or subsection (1) of section 200 (tree preservation orders: Forestry Commissioners) and, subject to the exceptions in regulation 14, no person shall-
 - (a) cut down, top, lop, uproot, wilfully damage, or wilfully destroy; or
 - (b) cause or permit the cutting down, topping, lopping, wilful damage or wilful destruction of,

any tree specified in the Schedule to this Order except with the written consent of the authority in accordance with regulations 16 and 17, or of the Secretary of State in accordance with regulation 23, and, where such consent is given subject to conditions, in accordance with those conditions.

Application to trees to be planted pursuant to a condition

4. In relation to any tree identified in the first column of the Schedule by the letter "C", being a tree to be planted pursuant to a condition imposed under paragraph (a) of section 197 (planning permission to include appropriate provision for preservation and planting of trees), this Order takes effect as from the time when the tree is planted.

Dated this 16th February 2017

The Common Seal of the COTSWOLD DISTRICT COUNCIL)
was hereunto affixed to this order in the presence of -)



Bhan Patel

Head of Legal and Property Services/~~Chief Executive/Strategic Director/Principal Solicitor~~

CONFIRMATION OF ORDER

This Order was confirmed by the Cotswold District Council without modification on the 26th day of April 2017

OR

This Order was confirmed by the Cotswold District Council, subject to the modifications indicated by

on the _____ day of _____ 20

Signed on behalf of The Cotswold District Council

S. Gargett

~~Head of Legal and Property Services/Chief Executive/Strategic Director/Principal Solicitor~~

Authorised by The Council to sign in that behalf

DECISION NOT TO CONFIRM ORDER

A decision not to confirm this Order was taken by Cotswold District Council
on the _____ day of _____ 20

Signed on behalf of The Cotswold District Council

.....
Head of Legal and Property Services/Chief Executive/Strategic Director/Principal
Solicitor
Authorised by The Council to sign in that behalf

VARIATION OF ORDER

This Order was varied by the Cotswold District Council on the
_____ day of _____ 20

by a variation order under reference number [*insert reference number to the variation
order*] a copy of which is attached]

Signed on behalf of The Cotswold District Council

.....
Head of Legal and Property Services/Chief Executive/Strategic Director/Principal
Solicitor
Authorised by The Council to sign in that behalf

REVOCATION OF ORDER

This Order was revoked by the Cotswold District Council on the
_____ day of _____ 20

under the reference number _____

.....
Head of Legal and Property Services/Chief Executive/Strategic Director/Principal
Solicitor
Authorised by The Council to sign in that behalf

SCHEDULE

SPECIFICATION OF TREES

TREES SPECIFIED INDIVIDUALLY (encircled in black on the map)

Reference on map	Description	Situation
T1	Oak	Land to east of Honeybourne Road Weston Subedge
T2	Oak	Land to east of Honeybourne Road Weston Subedge

TREES SPECIFIED BY REFERENCE TO AN AREA (within a dotted black line on the map)

Reference on map	Description	Situation
None		

GROUPS OF TREES (within a broken black line on the map)

Reference on map	Description	Situation
None		

WOODLANDS (within a continuous black line on the map)

Reference on map	Description	Situation
None		

S.G.

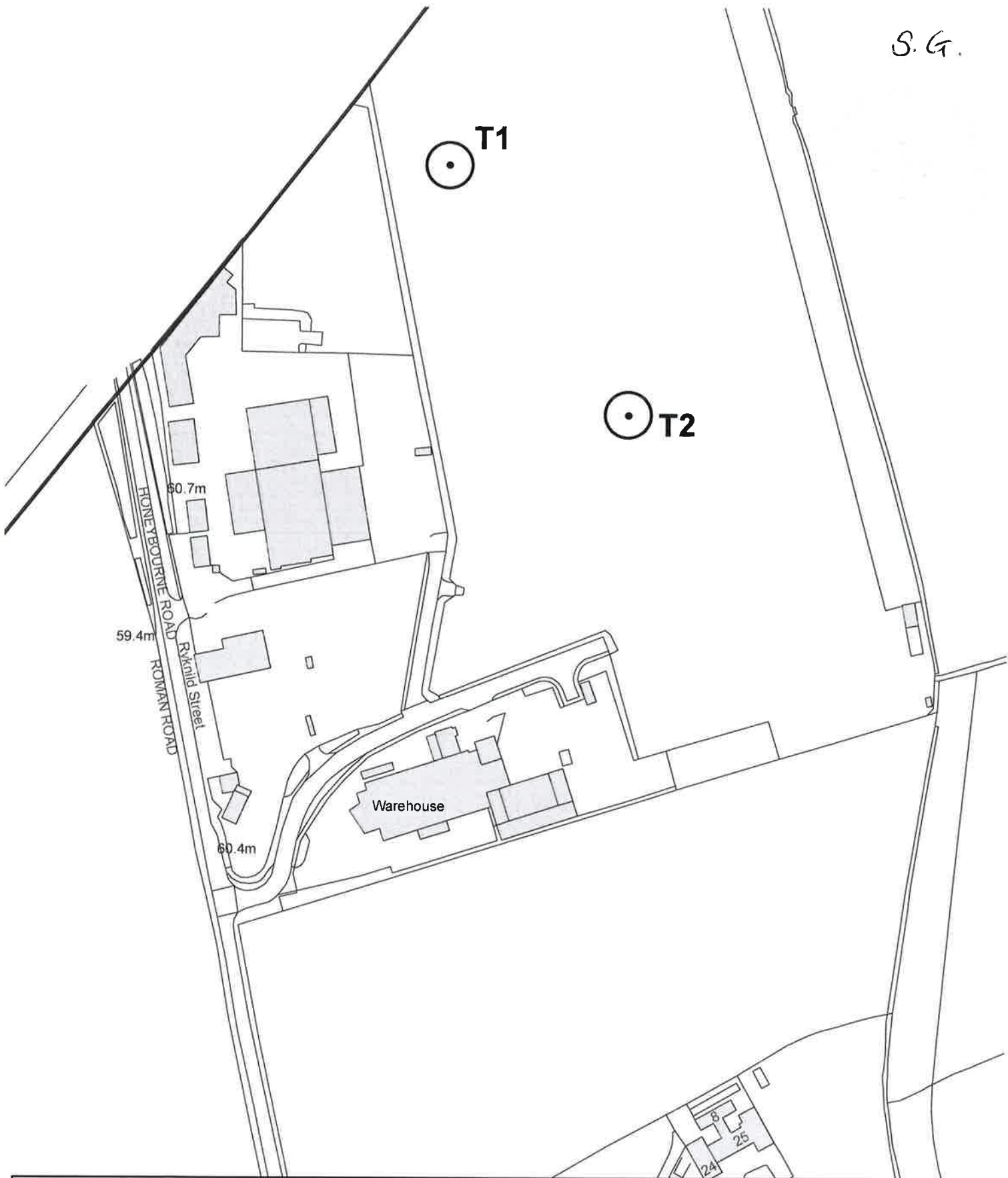

COTSWOLD DISTRICT COUNCIL

Tree Preservation Order

Buckle Mill, Honeybourne Road,
Weston Subedge, Gloucestershire.

Scale: 1:2500

Plan No: 17/00001

Date: 02 February 2017

© Crown copyright and database rights 2016. Ordnance Survey, LA No. 0100018800



Weston Industrial Estate

